

# Installation Instructions

## NOVA SUBFRAME ADJUSTABLE SUPPORT TUBES

*Please read these instructions completely  
**BEFORE** starting your installation!*

Your *HEIDTS* Hot Rod Shop Adjustable Support Tubes  
Contains The Following Items:

- 2) Firewall Mounting Brackets
- 2) Frame Mounting Brackets
- 2) Adjustable Support Tubes
- 1) Hardware Kit

Begin by installing your *HEIDTS* Hot Rod Shop Nova Subframe using the instructions included with that kit. Next bolt the frame mounting brackets to the frame rails using the hardware included with the subframe. Then install the firewall mounting brackets to the firewall using the hardware from the original front subframe. Install the tubes using the shoulder bolts and nylock nuts provided, making sure that the top ends and the bottom ends have the same threads, as the adjusters are left and right hand thread. Adjust to fit to the subframe as it is bolted up. You may have to adjust them again to align the fender gap after the car is down on the ground with weight on it.

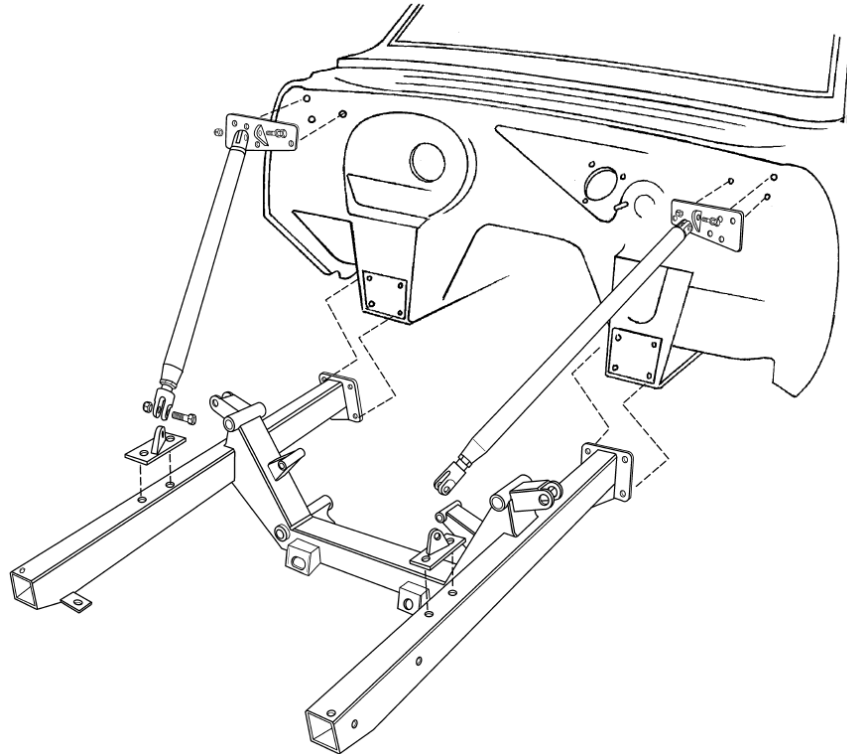

For questions on installations please call 800-841-8188 In Illinois (847) 487-0150

