

Installation Instructions

1955-1957 Chevy Tubular Upper Control Arms

Polished Stainless Steel

*Please read these instructions completely **BEFORE** Starting your installation!*

Parts List:

- 2) Polished Stainless Tubular Upper Control Arms
- 2) Ball Joint Boots
- 2) Ball Joint Nuts and Cotter Pins

NOTE: THE SHAFT BOLTS ARE INSTALLED HAND-TIGHT. THESE CONTROL ARMS HAVE OEM-STYLE MOLDED RUBBER BUSHINGS. THE CAR MUST BE SITTING AT RIDE HEIGHT, BEFORE THE BOLTS ARE SECURELY FASTENED.

Begin your installation by jacking up the front of the car and supporting it on sturdy jack stands. Remove the front wheels. Raise one side of the suspension with a floor jack. Remove the cotter pin and castle nut from the upper ball joint and loosen the ball joint from the spindle. Support the hub assembly, and remove the ball joint from the spindle. Remove the alignment nuts from the frame and remove the upper arm, keeping the shims in place. Trim off the top half of the rubber snubber with a sharp knife, to provide full suspension travel. Place the new *HEIDTS* Tubular Arm on the upper arm mount and install the shims and nuts. Install the boot on the ball joint, and insert the ball joint into the spindle. Tighten down with the castle nut and insert the cotter pin. Discard the remaining snap rings from the hardware kit. Release the jack and complete the installation on the other side of the car. Be certain to grease the ball joints upon completion. You will need to check the alignment of the front suspension, as the new cross shafts have an offset built into them to provide more caster and camber adjustment. If you have had trouble achieving correct alignment in the past, the front end should now be able to be fully aligned.

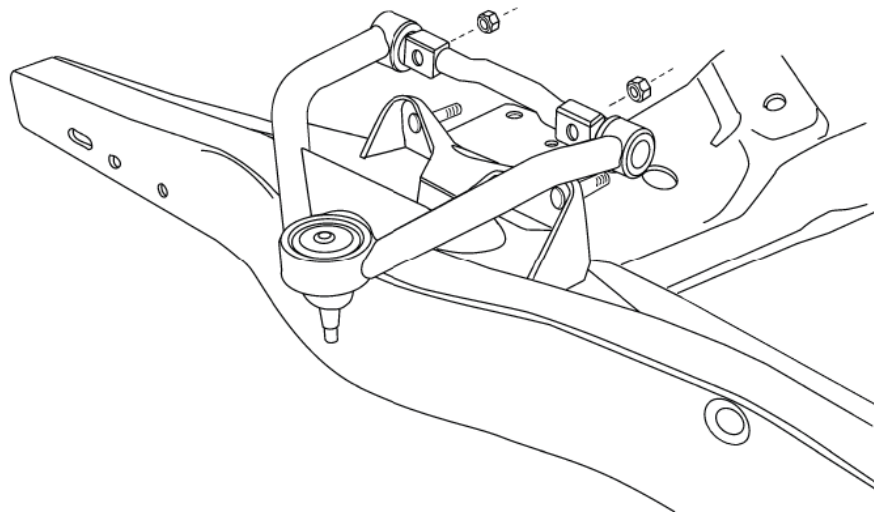

For questions on installations please call 800-841-8188 In Illinois (847) 487-0150

