

Installation Instructions

1955-1957 CHEVY TUBULAR LOWER CONTROL ARMS

*Please read these instructions completely **BEFORE** Starting your installation!*

Parts List:

2) Tubular Lower Control Arms

2) Ball Joint Boots*

1) Installation Hardware Kit

2) Ball Joint Nuts and Cotter Pins*

(* except -ST arms which use stock ball joints)

Begin your installation by jacking up the front of the car and supporting it on sturdy jack stands. Remove the front wheels. Raise one lower control arm with a floor jack. Remove the shock absorber. Using an internal spring compressor, compress the coil spring until it is loose in the lower control arm spring pocket. Remove the cotter pin and castle nut from the lower ball joint and remove the ball joint from the spindle. Swing the spindle aside, and swing the lower control arm down until the spring can be removed from the control arm. Unbolt and remove the lower arm. Install the new *HEIDTS* Tubular Lower Arm onto the frame and tighten in place. Insert the coil spring up into the frame, and swing the Lower Arm up into place. Install the boot on the ball joint, and insert the ball joint into the spindle. Tighten down with the castle nut and insert the cotter pin. Reinstall the shock absorber. Slowly release the jack, and complete the installation on the other side of the car. Be certain to grease the ball joints upon completion. Place the wheels back on, and place the car back on the ground. You may need to check the front suspension alignment, as the new control arms have new ball joints and may be seated different than the old ones.

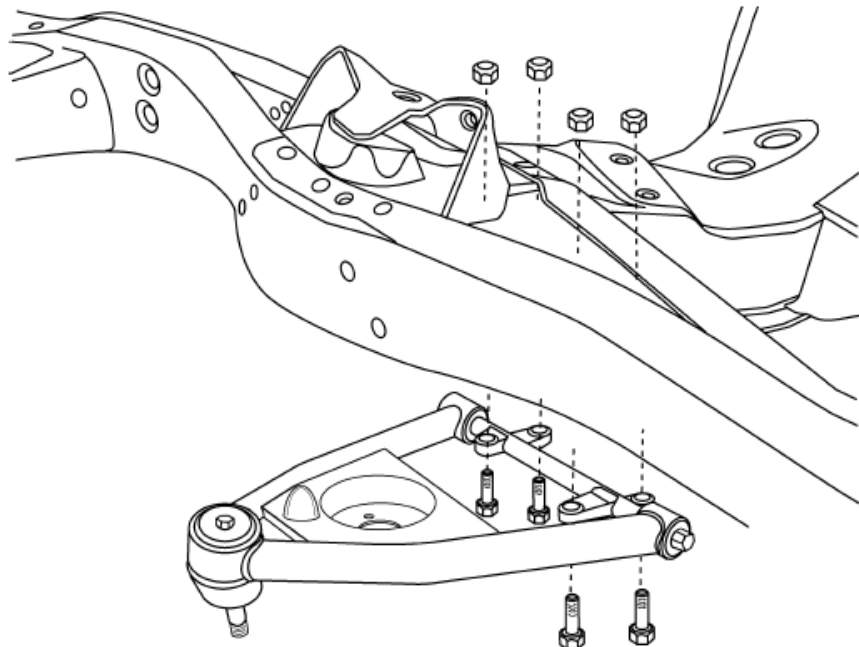

For questions on installations please call 800-841-8188 In Illinois (847) 487-0150

