

Installation Instructions

STABILIZER BAR BRACKET INSTALLATION

*Please read these instructions completely **BEFORE**
Starting your installation!*

Parts List:

- 2) Stabilizer Bar Brackets
- 4) 5/16-3/4" Hex Head Bolts
- 4) 5/16 Nylock Nuts
- 1) Drilling Template

If you are installing this bracket kit onto arms which do not have the holes already drilled for the brackets, you will need to drill them using the template provided. Cut it out and fold it on the dotted line. Place it on the top of the spring seat, around the spring base, and mark the holes through the paper. Next drill the holes to 11/32" Dia. Now you can go ahead and bolt the brackets onto the control arms using the bolts and nuts provided. You can continue installing the stabilizer bar, using its instructions.

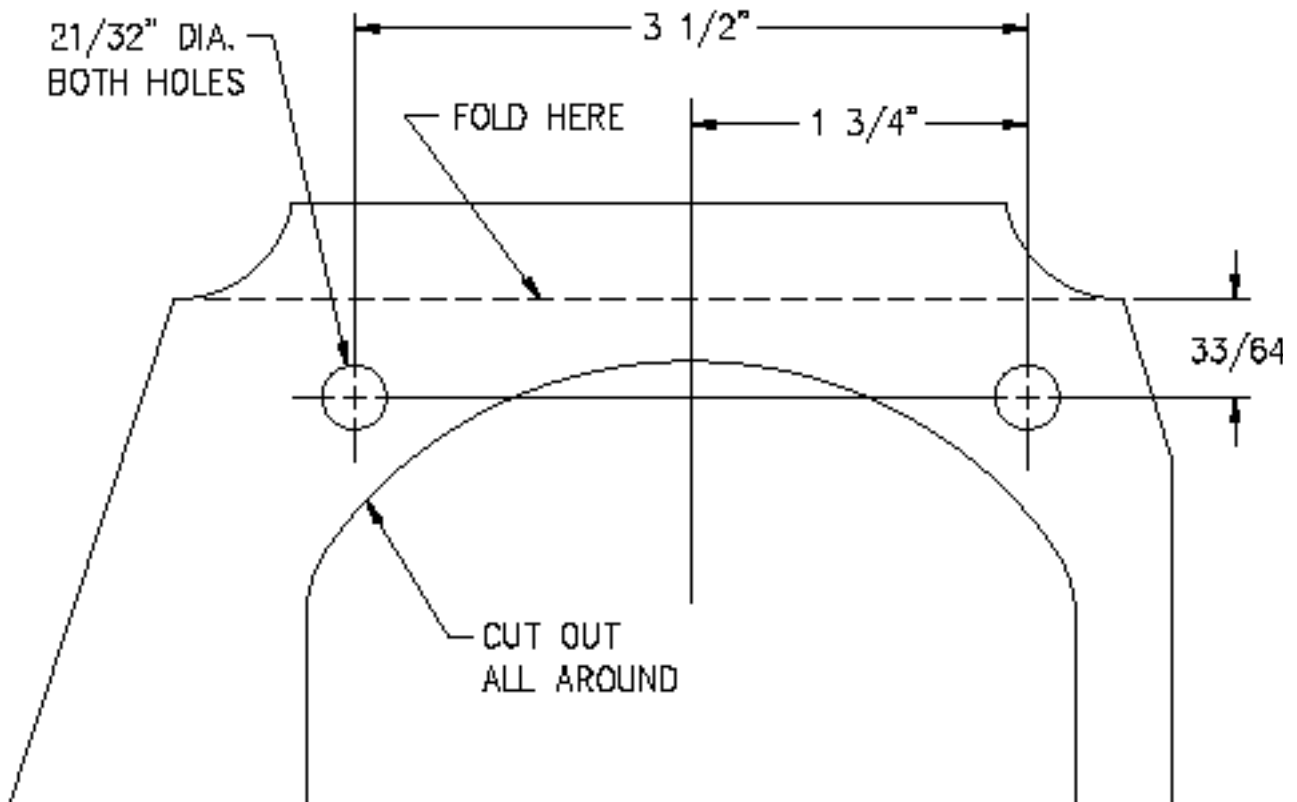

For questions on installations please call 800-841-8188 In Illinois (847) 487-0150

