

Installation Instructions

DISC BRAKE CONVERSION BRACKET KIT

USING 11" ROTORS and WILWOOD CALIPERS

*Please read these instructions completely
BEFORE starting your installation!*

Parts List

- | | |
|---|--------------------------------|
| 2) Brake Caliper Adapter Brackets-L & R | 4) Caliper Bolt Washers- Thick |
| 2) Long Adapter Mounting Bolts | 4) .015 Thk. Shim Washers |
| 2) Short Adapter Mounting Bolts | 8) .030 Thk. Shim Washers |
| 4) Caliper Mounting Bolts | |

Begin installation by positioning the Adapter Brackets on the spindles and inserting the mounting bolts. Tighten the lower bolts first, to ensure the brackets are square to the spindles. Now tighten the upper bolts. Loctite on these bolts is highly recommended. Install the rotors and bearings as usual. Slip the calipers on the rotors and Adapter Brackets next, with the bleeders pointing up. Select the correct shims for between the Adapter Brackets and the caliper bosses so the calipers are centered on the rotors. If the calipers end up slightly off center, the pistons in the calipers will self-adjust to equalize the pressure on both pads. Connect the brake lines & bleed the lines as normal procedure.

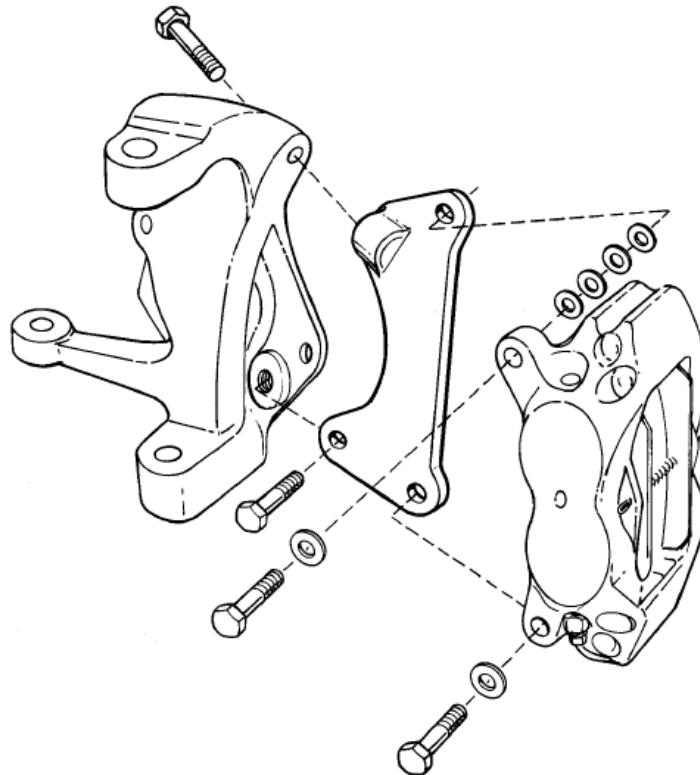

For questions on installations please call 800-841-8188 In Illinois (847) 487-0150

